

	LED	Specif.	Col.	Vetro/Glass
CNC50 T				
IK 10 20J xx9 $\frac{III}{III}$ Max 65°C CE	1 LED - 500mA 650lm - 6,5W - 14V real Max output lm 427	CL.III \mathcal{L}	▲	LL107016□
IP 68 \blacklozenge \blacklozenge \blacklozenge - 1m $\frac{III}{III}$ Max 280 Kg	1 LED - 24 V 650lm - 6,5W real Max output lm 427	CL.III \mathcal{L}	▲	LL107017□
<p>Versione ghiera tonda, possibile scelta di 3 differenti ottiche. Temperatura massima rilevata sul vetro 65°C.</p> <p>Version with round retaining ring, choice of 3 different optics. Max. temperature measured on the glass 65°C.</p> <p>Version avec virole ronde, choix possible de 3 optiques différentes. Température relevée sur le verre 65°C maxi.</p>				

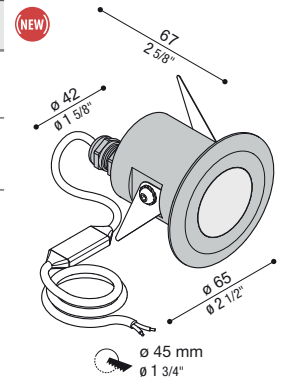

optic	led colour
S = 13°	N = (4000K)
M = 24°	3 = (3000K, lm -5%)
L = 53°	2 = (2700K, lm -5%)
D = Diff.	



	LED	Specif.	Col.	Vetro/Glass
CNC50 T Up				
IK 10 20J xx9 $\frac{III}{III}$ Max 65°C CE	1 LED - 500mA 650lm - 6,5W - 14V real Max output lm 427	CL.III \mathcal{L}	▲	LL107022□
IP 68 \blacklozenge \blacklozenge \blacklozenge - 1m $\frac{III}{III}$ Max 450 Kg	1 LED - 24 V 650lm - 6,5W real Max output lm 427	CL.III \mathcal{L}	▲	LL107023□
<p>Versione con diffusore in vetro sporgente ad alta diffondenza. Temperatura massima rilevata sul vetro 65°C.</p> <p>Version with protruding glass diffuser for high diffusion. Max. temperature measured on the glass 65°C.</p> <p>Version avec diffuseur en verre saillant à diffusion élevée. Température relevée sur le verre 65°C maxi.</p>				



led colour
N = (4000K)
3 = (3000K, lm -5%)
2 = (2700K, lm -5%)

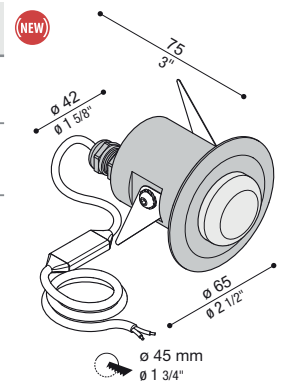

	LED	Specif.	Col.	Vetro/Glass
CNC50 Top L				
IK 10 20J xx9 $\frac{III}{III}$ Max 65°C CE	1 LED - 500mA 650lm - 6,5W - 14V real output lm 260	CL.III \mathcal{L}	▲	LL107018□
IP 68 \blacklozenge \blacklozenge \blacklozenge - 1m $\frac{III}{III}$ Max 2000 Kg	1 LED - 24 V 650lm - 6,5W real output lm 260	CL.III \mathcal{L}	▲	LL107019□
<p>Versione ghiera top con apertura a 110°. Temperatura massima rilevata sul vetro 65°C.</p> <p>Version with Top retaining ring with 110° opening. Max. temperature measured on the glass 65°C.</p> <p>Version avec virole Top ouverture à 110°. Température relevée sur le verre 65°C maxi.</p>				



led colour
N = (4000K)
3 = (3000K, lm -5%)
2 = (2700K, lm -5%)

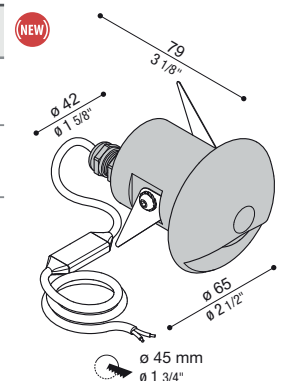

	LED	Specif.	Col.	Vetro/Glass
CNC50 Top 2L				
IK 10 20J xx9 $\frac{III}{III}$ Max 65°C CE	1 LED - 500mA 650lm - 6,5W - 14V real output lm 453	CL.III \mathcal{L}	▲	LL107020□
IP 68 \blacklozenge \blacklozenge \blacklozenge - 1m $\frac{III}{III}$ Max 2000 Kg	1 LED - 24 V 650lm - 6,5W real output lm 453	CL.III \mathcal{L}	▲	LL107021□
<p>Versione ghiera con 2 aperture da 110°. Temperatura massima rilevata sul vetro 65°C.</p> <p>Version with Top retaining ring with two 110° openings. Max. temperature measured on the glass 65°C.</p> <p>Version avec virole Top 2 ouvertures à 110°. Température relevée sur le verre 65°C maxi.</p>				



led colour
N = (4000K)
3 = (3000K, lm -5%)
2 = (2700K, lm -5%)

